

Selection
PremiumEdition



Design and technology in an exciting symbiosis



Markus Rüegg and Gerhard Manfred Rokossa

Two companies, one concept: Best products in terms of design and technology for a greater sense of well-being in any environment. Both partners stand for innovative, esthetically attractive shapes expressing an ultra-modern and timeless design. **Spartherm** is the market leader for high-quality and efficient heating applications in Germany. The spark has bridged the gap between these two companies, between industry and trade, and the outcome is an even more attractive set of designs for a living fire in the home. The symbiosis purist design with archaic steel and superlative fuel cell technology transforms fire into a new living dimension. This gives rise to excellent fireplaces for all those who are enthused by exceptional and unusual design.

Fireplace as furniture for contemporary interiors

Regardless of whether those people are involved in architecture, energy usage, residential environments or materials - nowadays, we are all living differently. Cubic designs with many windows and open-plan spaces are enthusing growing numbers of people. In terms of environmental credentials, Spartherm ensures that its stoves deliver high efficiency, clean combustion and are CO₂-neutral in operation. Our residential worlds have been transformed too. Open-plan layouts, large bright

rooms and, as the highest expression of home-comfort and well-being: the ancient fire within your modern living space. We may live incredibly diverse lives nowadays, and this diversity is reflected in the different ways we may choose to situate modern fireplaces in our homes: Installed against a wall or free-standing somewhere in the room. That is because, today, fire is so much more than fire - it is a sought-after item of interior furnishing, one that we experience through all our senses.

Architecture

*Cubic, clear, flooded with light –
Outside world and interior spaces
blend into a holistic experience for
the senses.*



*Energy and the environment
The very latest of construction
materials and efficient heating
technology protect our resources
and create a sense of comfortable
well-being.*

*Residential shapes
Flowing transitions between
the different living spaces
open up new perspectives
for us.*

*Material
Unusual materials, sensual
textures and exciting colour
combinations define high-
lights.*

Square. Convenient. Contemporary.

Attachments and boxes are an ideal way of enhancing your own personalised, fire island! Available in 3 different colours Nero, White and Steel, you can combine these cubic elements to create exceptionally versatile, feel-good interiors – all centred around fire. Suitable for use as storage compartments, a wood store, a stove bench seat or a sideboard – this modular system layout underscores

the pleasurable impact on our senses and the appealing aesthetic properties of stoves. They create, residential landscapes', favourite places, oases of retreat and a representative ensemble of fire and steel that warms the heart.

The fact that the practical can also be beautiful is proven by the modular items of steel furniture designed by Markus Rüegg.



The magnet connectors offer a great variety of installation options and can easily be attached to each other.

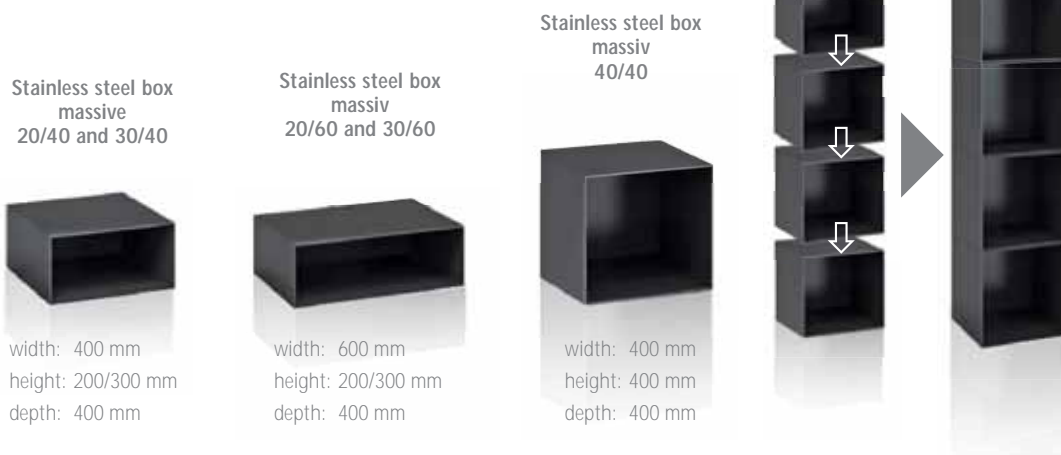

ARES 'steel fire furniture' – geometric beauty

Where fire and steel merge to form a single unit, then the time for ARES is upon us. Glass on 3 sides provides a clear view of the exciting interplay of living flames. 172 centimetres of pure geometric beauty. Seamless design, precision build and fascinating functionality. All these qualities characterised the ARES range of 'steel fire furniture'.



ARES steel fire furniture Unit with steel cladding

- Two model variants: Wall model or free-standing
- Glass on 3 sides
- Push-up window
- Various colour variants: Nero, White, Steel, VAG
- Flue gas outlet: At top or at back
- Flue gas outlet: Ø 200 mm

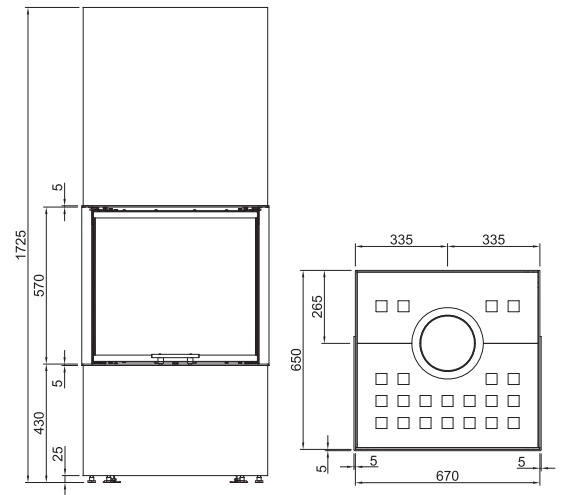

Technical data: ARES

Fuel	Logs
Nominal heat output	7,5 kW
Wood feed quantity	2,1 kg/h
Thermal output range min/max	5,3 - 9,8 kW
Efficiency	> 80 %
Weight wall model	420 kg
Weight free-standing	480 kg
CO emission at 13% O ₂	< 1250 mg/Nm ³
Dust content	< 40 mg/Nm ³

Closed operation

Flue gas temperature at the connecting socket	310 °C
Supply pressure	12 Pa
Mass flow of flue gas	7,0 g/s

Open operation

Flue gas temperature at the connecting socket	310 °C
Supply pressure	7 Pa
Mass flow of flue gas	23,7 g/s

Accessories

SVS connection	✓
----------------	---

Fire protection

to combustible components to be protected	
Additional walling	10 cm
Rear insulation Calciumsilicate	8 cm
to non-combustible, non-protected components	
Rear insulation Calciumsilikat	8 cm

Tests and values

Non self-closing combustion chamber door	✓
Self-closing combustion chamber door	✓
Operation with opened door	✓
1st. BlmSchV 2nd.	✓
Austria §15a	✓

ARTEMIS steel fire furniture – worth a closer look!

ARTEMIS steel fire furniture captivates our senses with its minimalist vocabulary of shapes. Always in focus: A crackling fire for those most comfortable of being-at-home feelings. Invest in a pleasure to behold and enjoy the incomparable delight for the senses of a living fire in the heart of your home.



ARTEMIS steel fire furniture Unit with steel cladding

- Two model variants: Wall model or free-standing
- Glass on 3 sides
- Push-up window
- Various colour variants: Nero, White, Steel, VAG
- Flue gas outlet: At top or at back
- Flue gas outlet: Ø 200 mm

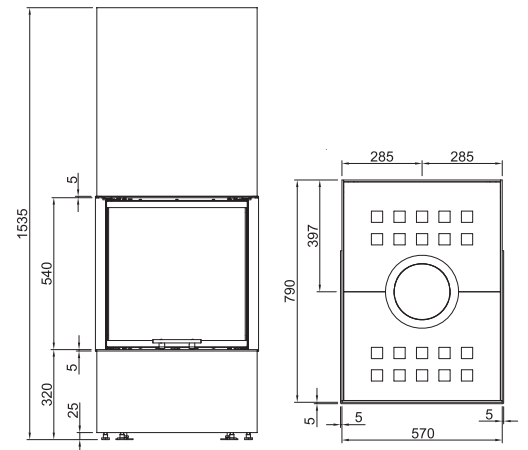

Technical data: ARTEMIS

Fuel	Logs
Nominal heat output	9,0 kW
Wood feed quantity	ca. 2,8 kg/h
Thermal output range min/max	6,3 - 11,7 kW
Efficiency	80 %
Weight wall model	410 kg
Weight free-standing	460 kg
CO emission at 13% O ₂	< 1250 mg/Nm ³
Dust content	< 40 mg/Nm ³

Closed operation*

Flue gas temperature at the connecting	310 °C
Supply pressure	12 Pa
Mass flow of flue gas	8,6 g/s

Accessories

SVS connection	✓
----------------	---

Fire protection

to combustible components to be protected

Additional walling	10 cm
Rear insulation Calciumsilicate	8 cm

to non-combustible, non-protected components

Rear insulation Calciumsilikat	8 cm
--------------------------------	------

Tests and values

Non self-closing combustion chamber door	✓
Self-closing combustion chamber door	✓
Operation with opened door	no
1st. BImSchV 2nd.	✓
Austria §15a	✓

*Open operation not allowed

ATHENE steel fire furniture – symbolic fire

An item of steel fire furniture from Markus Rügge is an immediate eye-catcher: Distinctive, clear design lines, intelligent internal life, convincing efficiency. ATHENE fires our imagination and our life with unforgettable moments.

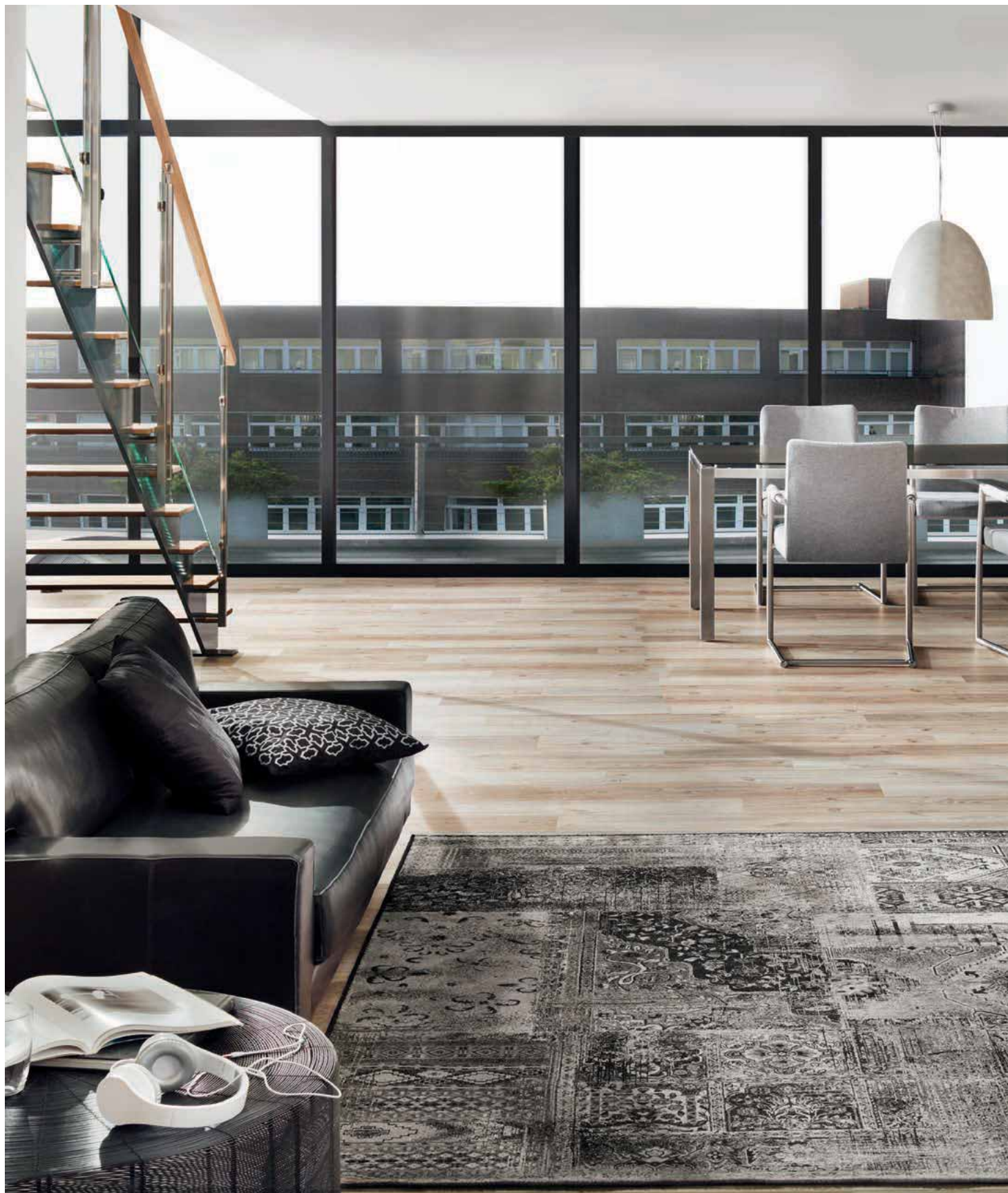

ATHENE steel fire furniture Unit with steel cladding

- Glazed on 2 sides: Right or left
- Window folds open sideways
- Various colour variants: Nero, White, Steel, VAG
- Flue gas outlet: At top or at back
- Flue gas outlet: Ø 150 mm
- Optional: Heat accumulator and modular cladding elements

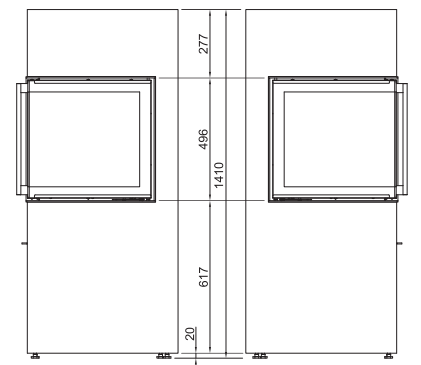

Athene L
open at the front and left

Athene R
open at the front and right

Technical data: ATHENE

Fuel	Logs
Nominal heat output	6,0 kW
Wood feed quantity	1,8 kg/h
Thermal output range min/max	4,2 - 7,8 kW
Efficiency	80 %
Weight (without storage stones)	270 kg
Weight storage stones	45 kg (3 x 7 kg and 1 x 24 kg)
CO emission at 13% O ₂	< 1250 mg/Nm ³
Dust content	< 40 mg/Nm ³
Flue gas temperature at the connecting	254 °C
Supply pressure	12 Pa
Mass flow of flue gas	7,3 g/s

Fire protection

to combustible components to be protected

Distance to rear wall	6 cm
Distance to the side wall	6/20 cm
Radiation range	80 cm

to non-combustible, non-protected components

Distance to rear wall	5 cm
Distance to the side wall	5 cm
Radiation range	80 cm

Tests and values

Non self-closing combustion chamber door	✓
Self-closing combustion chamber door	✓
Operation with opened door	no
1st. BImSchV 2nd.	✓
Austria §15a	✓

*Open operation not allowed

Your specialist dealer

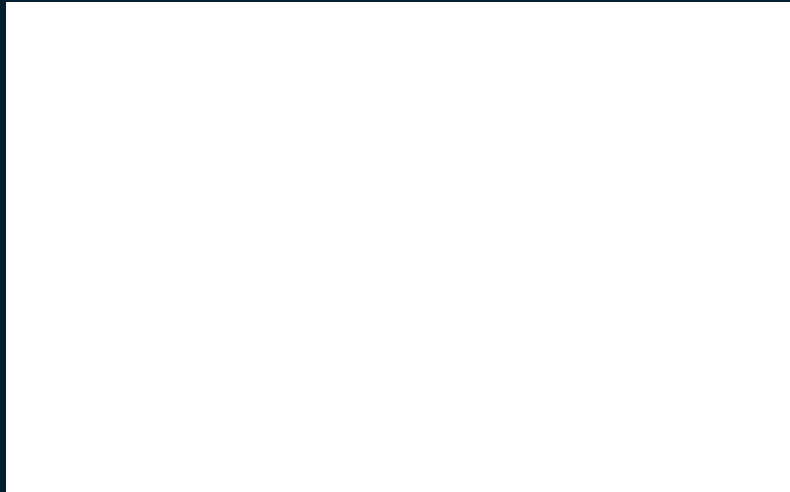

SPARTHERM Feuerungstechnik GmbH
Maschweg 38
D-49324 Melle
Tel. +49 54 22/94 41-0
Fax +49 54 22/94 41-14
info@spartherm.com
www.spartherm.com